

The Sea Ranch

Street Name	location	Street Name	location	Street Name	location	Street Name	location	Street Name	location	Street Name	location	Street Name	location	Street Name	location
Airport-Private	25	Captain's Close	Unit 1	East Ridge Road	30A	Haversack	35D	Moancker Recreation Center	1	Rock Cod	35B-35E	Sorcerer Wood	Unit 30A	Westerly Close	19
Albatross Reach	Unit 18	Canonius	39A	Equinox	35E	Headland's Close	30	Navigator's Reach	1-4-5	Schooner Drive	Unit 19	Sounding	39C	Westgate Drive	13
Anchorage Close	17	Chapel-The Sea Ranch	38	Fawn	35E	Headland's Reach	Unit 18	North Star Close	Unit 17	Screetch Over	34A	South Wind	34A	Whalebone Reach	24
Annapolis Road	12-12-20	Children's Play Park	35D	Fernwood	Unit 14	Hedgrate Road	21	North Star Close	5	Sculpture Point Drive	17	Spar Close	20	Whaler's Reach	7
Antler	35A	Chinquapin Lane	5	Fish Hook	35A	Hedgrow Close	18	Ohlson Ranch Center	18A	Sea Drift	34A	Spindrift Close	3	White Barn	36A
Arch Rock Road	19	Clayton's Reach	17	Fish Rock	35A	Helm	35C	Ogry Reach	28	Sea Forest Drive	10-10A	Spring Meadow	4	White Fir Wood	29A
Backpack	35C	Compass Close	3	Fisher's Close	7	Heron	34A	Otter Close	24	Sea Gate Road	7-17	Spur Close	30-30A	White Tail	35D
Badger	35D	Conifer Close	20	Fly Cloud Close	30	Horizon Reach	3	Pacific Reach	19	Sea Lion	35B	Starboard	30	Whitesurf Road	18
Ballet	35E	Contemplation Close	12	Fly Cloud Road	12-13	Hot Spot Picnic Area	25A	Packet Close	24	Sea Meadow Drive	7	Stables-Equestrian Facility	18-21	Wildberry Close	18
Bear Grass Close	31	Foothill Close	21	Forecastle	27	Indian Close	5	Pelican	34A	Sea Pine Reach	35C	Starboard	35C	Wildfern Close	19
Big Tree Close	27A	Comorant Reach	21	Foremast	35E	Klamath	35C	Pilot's Reach	20	Sea Ranch Lodge	8	Stone Crop Reach	31	Wild Iris	36A
Black Point Close	1	Comorant Close	39A	Galleon's Reach	34A	Land's End Close	21	Pine Cone	35D	Sea Ridge Road	20-30	Taliglass Lane	35C	Wild Moor Reach	4
Black Point Reach	1	Cornwall	3	Crow's Nest Drive	3	Larkspur Close	31	Pine Meadow Road	29A	Sea Shark	35C	Tide Pool	34A	Windsong Lane	24
Bluff Reach	21	Cypress Close	24	Curlew Reach	35A-35D	Leeward Road	24-28-35A-35C-35E	Pine Tree Close	3	Sea Walk Drive	2-11	Timber Close	3	Windrow	35C
Bosun's Reach	1	Deer Woods Drive	14	Cypress Close	18	Leeward Spur	28	Pines Close	27A	Sea Watch Close	24	Timer Ridge Road	5-10-13-19	Windsweep	35C
Bowprint Close	1	Deer Woods Drive	14	Green Cove Drive	19-30	Longmeadow Road	19	Pipers Reach	24	Seabird Road	19	Top Mast Close	21	Yardarm Drive	15
Breaker Reach	21	Deer Trail	35A	Green Fern Close	35D	Lumberjack Close	5	Ramsgate Close	28	Seal Rock Reach	3	Vantage Road	28		
Brigantine Reach	1	Dog Park	21	Green Cove Drive	19-30	Lumberjack Close	5	Ramsgate Close	28	Seaward Ranch	20	Walk-On Beach	21		
Broad Reach	35B	Deerfield Road	27-27A	Green Cove Drive	19-30	Lumberjack Close	5	Ramsgate Close	28	Seaward Ranch	20	Walk-On Beach	21		
Buckeye	35E	Del Mar Point	35C-35E	Green Cove Drive	19-30	Lumberjack Close	5	Ramsgate Close	28	Seaward Ranch	20	Walk-On Beach	21		
Burl Tree	34A	Del Mar Center	34A	Green Cove Drive	19-30	Lumberjack Close	5	Ramsgate Close	28	Seaward Ranch	20	Walk-On Beach	21		
Business Center	28	Driver's Close	19	Green Cove Drive	19-30	Lumberjack Close	5	Ramsgate Close	28	Seaward Ranch	20	Walk-On Beach	21		
Cabrillo Close	Unit 18	Dune Drift Close	28	Green Cove Drive	19-30	Lumberjack Close	5	Ramsgate Close	28	Seaward Ranch	20	Walk-On Beach	21		

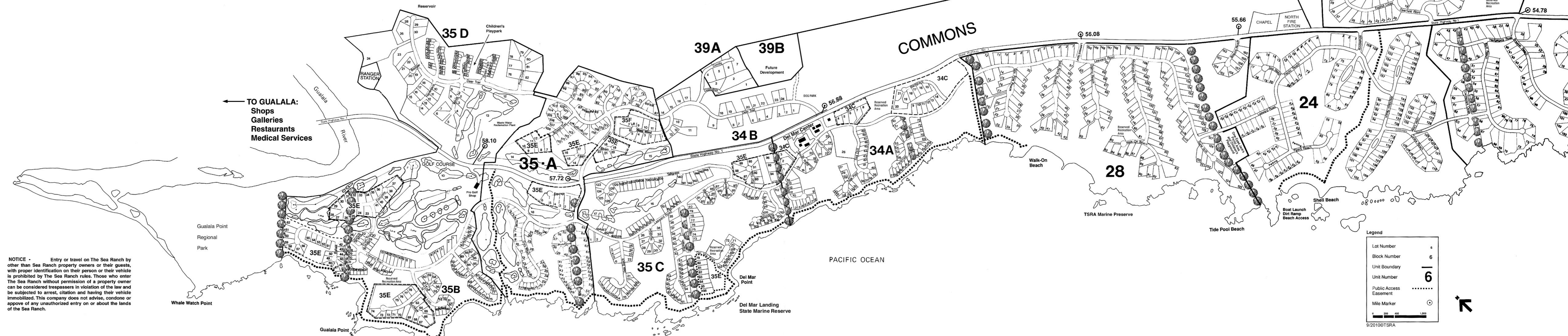

NOTICE - Entry or travel on The Sea Ranch by other than Sea Ranch property owners or their guests, with proper identification on their person or their vehicle is prohibited by The Sea Ranch rules. Those who enter The Sea Ranch without permission of a property owner can be considered trespassers in violation of the law and be subjected to arrest, citation and having their vehicle immobilized. This company does not advise, condone or approve of any unauthorized entry on or about the lands of the Sea Ranch.

← **TO GUALALA:**
Shops
Galleries
Restaurants
Medical Services

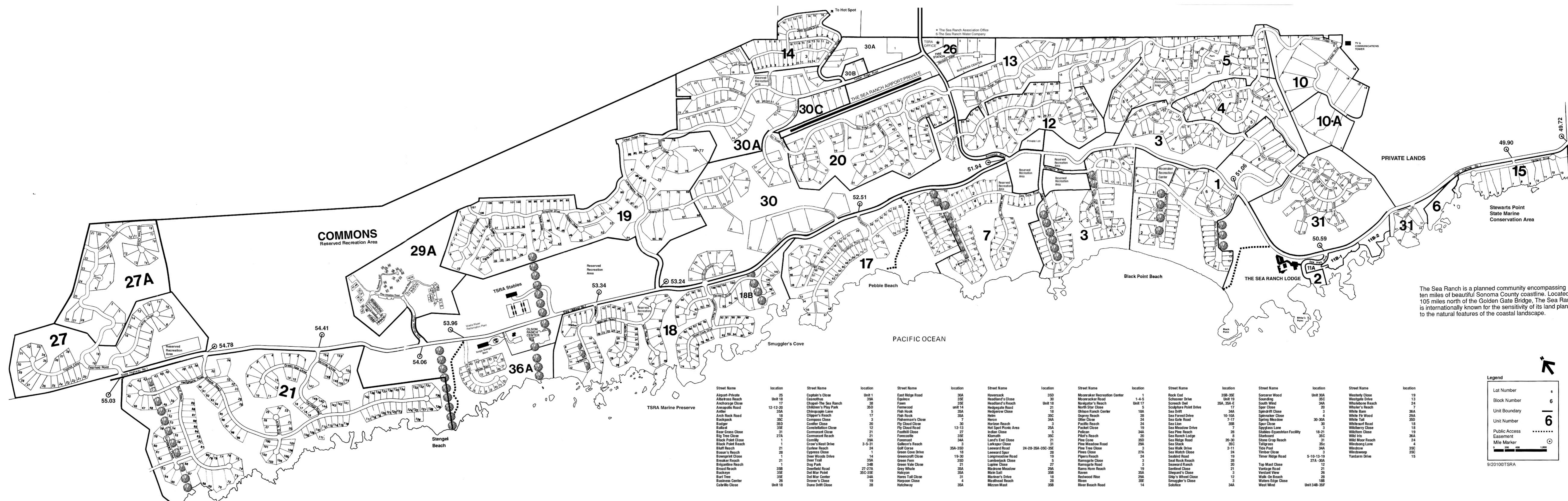

The Sea Ranch is a planned community encompassing ten miles of beautiful Sonoma County coastline. Located 105 miles north of the Golden Gate Bridge, The Sea Ranch is internationally known for the sensitivity of its land planning to the natural features of the coastal landscape.

Street Name	location	Street Name	location	Street Name	location	Street Name	location	Street Name	location	Street Name	location
Airport-Private	25	Captain's Close	Unit 1	East Ridge Road	30A	Haversack	35D	Moonraker Recreation Center	1	Rock Cod	35B-35E
Albarran Reach	39A	Casamitus	39A	Eggnox	35E	Headmist's Close	30	Moonraker Road	1-4-5	Schooner Drive	Unit 19
Anchorage Close	17	Chapel-The Sea Ranch	38	Fawn	35E	Navigator's Reach	Unit 17	Screench Owl	35A, 35A-E	Whalebone Reach	34A
Annapolis Road	12-12-20	Children's Play Park	35D	Fernwood	Unit 14	Hedgegate Road	21	Sculpture Point Drive	17	Spar Close	20
Arch Rock Road	35A	Chingupin Lane	5	Fish Hook	35A	Hedgeview Close	18	Sea Drift	34A	Spindrift Close	3
Backpack	35C	Clipeper's Reach	35A	Fish Rock	35A	Helm	35C	Sea Forest Drive	28	Spinnaker Close	4
Badger	35D	Compass Close	3	Fisherman's Close	7	Heron	34A	Sea Gate Road	7-17	Spring Meadow	30-30A
Balfour	35E	Conifer Close	20	Fly Cloud Close	30	Horizon Reach	3	Sea Lion	35B	Spur Close	30
Bear Grass Close	31	Constellation Close	12	Hot Spot Picnic Area	25A	Indian Close	5	Sea Meadow Drive	7	Spriglass Lane	3
Big Tree Close	27A	Cormorant Close	21	Footbill Close	27	Klamath	35C	Sea Pine Reach	28	Stables-Equestrian Facility	18-21
Black Point Close	35E	Cormorant Reach	21	Forecastle	35E	Land's End Close	21	Sea Ranch Lodge	8	Starboard	35C
Black Point Reach	1	Comolly	39A	Foremast	34A	Larkspur Close	35D	Sea Ridge Road	20-30	Stonewall Road	18
Bluff Reach	21	Crow's Nest Drive	3-5-31	Galleon's Reach	31	Leeward Road	24-28-35A-35C-35E	Sea Stack	29A	Spriglass Lane	3
Bosun's Reach	28	Cypress Close	1	Green Cove Drive	18	Leeward Spur	2	Sea Walk Drive	2-11	Tide Pool	34A
Bowscott Close	1	Deer Woods Drive	35A	Longmeadow Road	19-30	Lumberjack Close	25	Sea Watch Close	24	Timber Close	3
Breaker Reach	35A	Deer Trail	35D	Green Fern	35D	Lupine Close	27	Sasbar Road	19	Timer Ridge Road	5-10-13-19
Brigantine Reach	1	Dog Park	21	Grey Whale	35A	Madrone Meadow	26A	Seal Rock Reach	28	Top Mast Close	12
Broad Reach	35B	Deepfield Road	27-27A	Halycon	35A	Main Sail	35B	Seaward Ranch	20	Vantage Road	21
Buckeye	35E	Del Mar Point	35C-35E	Hares Tail Close	31	Mariner's Drive	18	Seaward View	28	Venture View	26
Burl Tree	34A	Drawer's Close	19	Harpoon Close	4	Masthead Reach	3	Ship's Wheel Close	12	Walk-On Beach	28
Business Center	26	Dune Drift Close	28	Hatchway	35A	Mizen Mast	35B	Smuggler's Close	3	Waters Edge Close	35C
Cabrillo Close	Unit 18							Solstice	34A	West Wind	Unit 134B-35F

Legend

- Lot Number: 6
- Block Number: 6
- Unit Boundary: —
- Unit Number: 6
- Public Access Easement:
- Mile Marker: 0, 200, 400, 1,000